

# Schlumpf Ergonomic Handling Systems



- Low Cost
- Modular Design
- Simple Function
- Made In U.S.A.
- Safe, Easy and Economical



**ERT-350** electric roll handling machines make lifting, turning and transporting rolls of all types with weights to 350 lbs (159 kg) safe and easy.

The **ERT-350** has quiet, high-speed electric actuators powering the turning function which has the capability of completing the full radius in 8 to 10 seconds. The 2 station push button switch is mounted within a small, hand held pendant for the operators convenience.

The **ERT-350** utilizes Schlumpf's Universal Mandrels which are available for most core sizes. Simply insert the mandrel into the core and lift the roll. The mandrel grips the core with minimal damage. A quick-change mandrel holder allows fast core size changes without any tools.

**LIFT · TURN · TRANSPORT · LOAD · UNLOAD  
· STACK · STORE · PACKAGE · PALLETIZE**

The ERT-350 is perfectly balanced and turns rolls to a precise horizontal or vertical position with the touch of a button. The unique floating turner arm makes it easy to release the mandrel both in the vertical and horizontal orientation.



"Back Injuries - Nations Number One Workplace Safety Problem." The U.S. Department of Labor reports that more than one million workers suffer back injuries in the U.S. each year, costing industry billions of dollars on top of the pain and suffering borne by employees. Schlumpf Ergonomic Handling Systems will minimize or eliminate the risk of operator injury and maximize productivity and profits.

**ERT-350 Electric Roll Turner**

## Standard Features:

High speed turning mechanism.  
Handles a wide range of roll sizes and weights.  
Easy to position and control.  
Rugged steel construction.  
Modular design.  
Made in U.S.A.

## Specifications:

Max Roll Width: 33" (838.2 mm)  
Max Roll O.D.: 36" (914.4 mm)  
Max Roll Weight: 350 lbs (159 kg)  
Paper cores with 3" or 6" I.D.  
Power Source: 115 volt AC  
Operator Interface: Hand held pendant with horizontal/vertical switches.  
Machine Weight: 140 lbs (64 kg)

## Options & Accessories:

Single or 2 speed Hoist Controls.  
Handle Bar  
Anti-telescope Attachment  
Expanding mandrels 3" (76 mm) to 12" (304.8 mm)  
Pneumatic mandrel retract with switching  
Anti-telescoping attachment with manual clamp  
Anti-telescoping attachment with pneumatic clamp  
Custom configurations available

**Minimize Risk. Maximize Profits!**

Distributed By:

Specifications and dimensions subject to changes without notice.  
Consult Schlumpf for current drawings! Published 04-2005.



**schlumpf**

innovation. performance. quality.



\*Upon Request

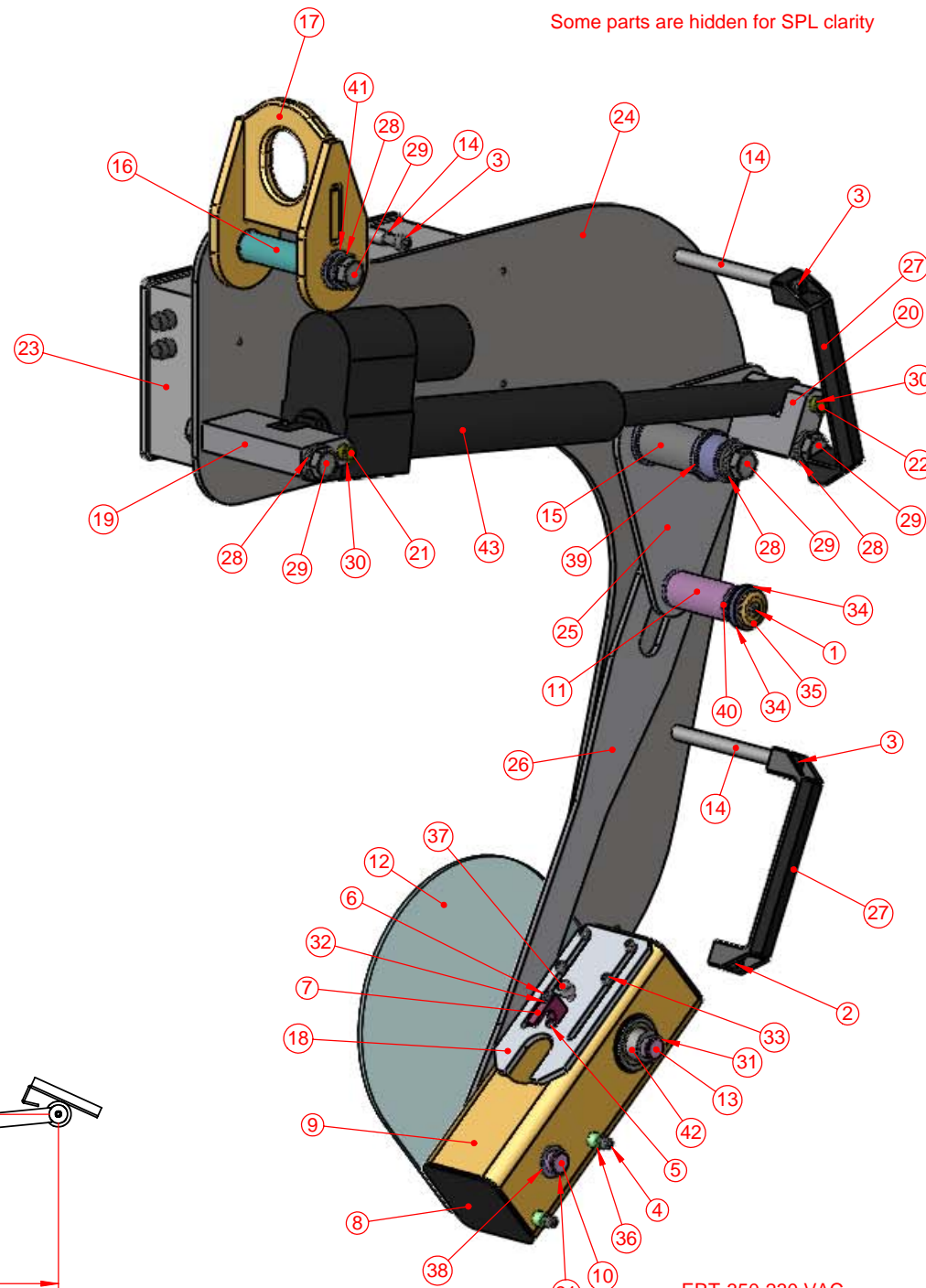
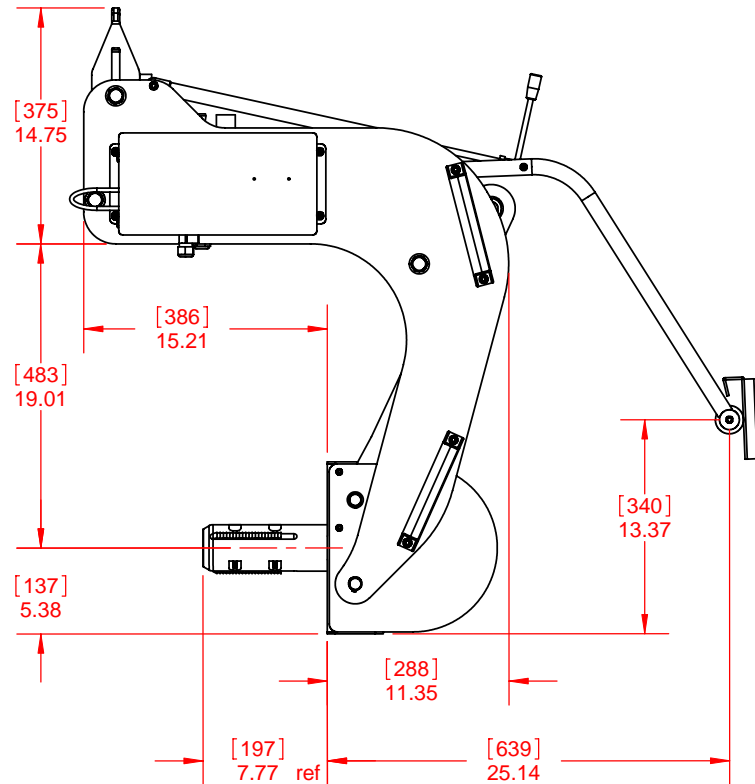
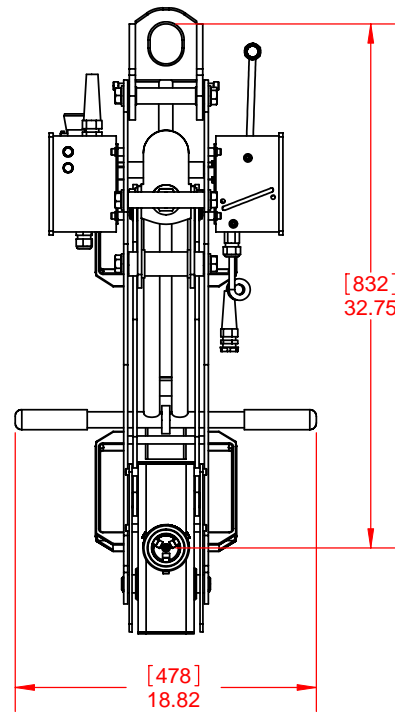

Some parts are hidden for SPL clarity

ITEM NO.	PART NUMBER	DESCRIPTION	QTY.
1	K040062	M6 x 1.0 x 16 Socket FCHS	2
2	K040125	M8 x 1.25 x 12 Hex SHCS	4
3	K040127	M8 x 1.25 x 25 Hex SHCS	6
4	K040193	M6 x 1.0 x 25 Hex SHCS	4
5	K040278	M4 x 0.7 x 6 Hex SHCS	1
6	K040288	M4 x 0.7 x 30 Hex SHCS	1
7	L-10003-28	Captive Support	1
8	L-10159-03R1	ABS Cover (1/4 wall)	2
9	L-10335-04R2	ERT-350 Turner Arm	1
10	L-10335-06	ERT Turner Link Shaft	1
11	L-10335-07R1	Cam Link Shaft	1
12	L-10335-15R3	ERT Turner Guard	2
13	L-10387-01	ERT Turner Shaft	1
14	L-10387-05	ERT Spacer Rod	3
15	L-10387-06	Cam Pivot Shaft	1
16	L-10438-05	Hoist Hook Spacer Rod	1
17	L-10438-06	Hoist Hook Weldment	1
18	L-10510-08	Mandrel Locking Plate	1
19	L-10639-02R2	ERT motor end clevis mount	1
20	L-10639-03R3	ERT rod end clevis mount	1
21	L-10639-04R1	ERT motor end clevis shaft	1
22	L-10639-05R1	ERT rod end clevis shaft	1
23	L-10789-01	ERT control box 230VAC std turner & ERR	1
24	L-10789-02	ERT-350 Frame Plate	2
25	L-10789-03	ERT-350 Cam Link	2
26	L-10789-04	ERT-350 Turner Link	2
27	P-10033	Plastic Pull Handle	4
28	P-10054	M16 Lock Washer	8
29	P-10099	M16 x 2.0 x 30 HHCS	8
30	P-10123	1/2" Ext. Retaining Ring	4
31	P-10135	3/4" Snap Ring	4
32	P-10337	M4 Lock Washer	1
33	P-10363	1/4 x 5/16 Shoulder Bolt	4
34	P-10672	1" shim washer	4
35	P-10674	M6 Finish Washer	2
36	P-10805	3/8" Spacer	4
37	P-10829	retracting thumb screw	1
38	P-40334*	3/4" x 1/2" long flange bushing	2
39	P-40335*	1-1/4" x 1" long flange bushing	2
40	P-40336*	3/4" x 3/4" long flange bushing	2
41	P-40373*	1" ID polymer flange bushing	2
42	P-40374*	3/4" ID Radial Ball Bearing	2
43	P-50744*	2000lb linear actuator 8" stroke	1

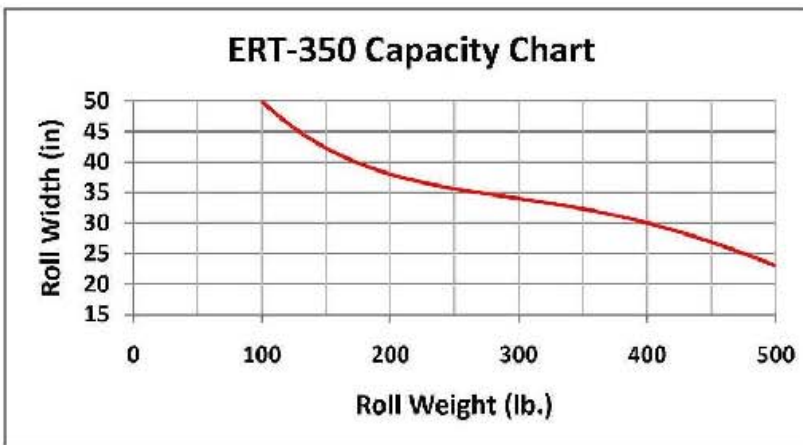
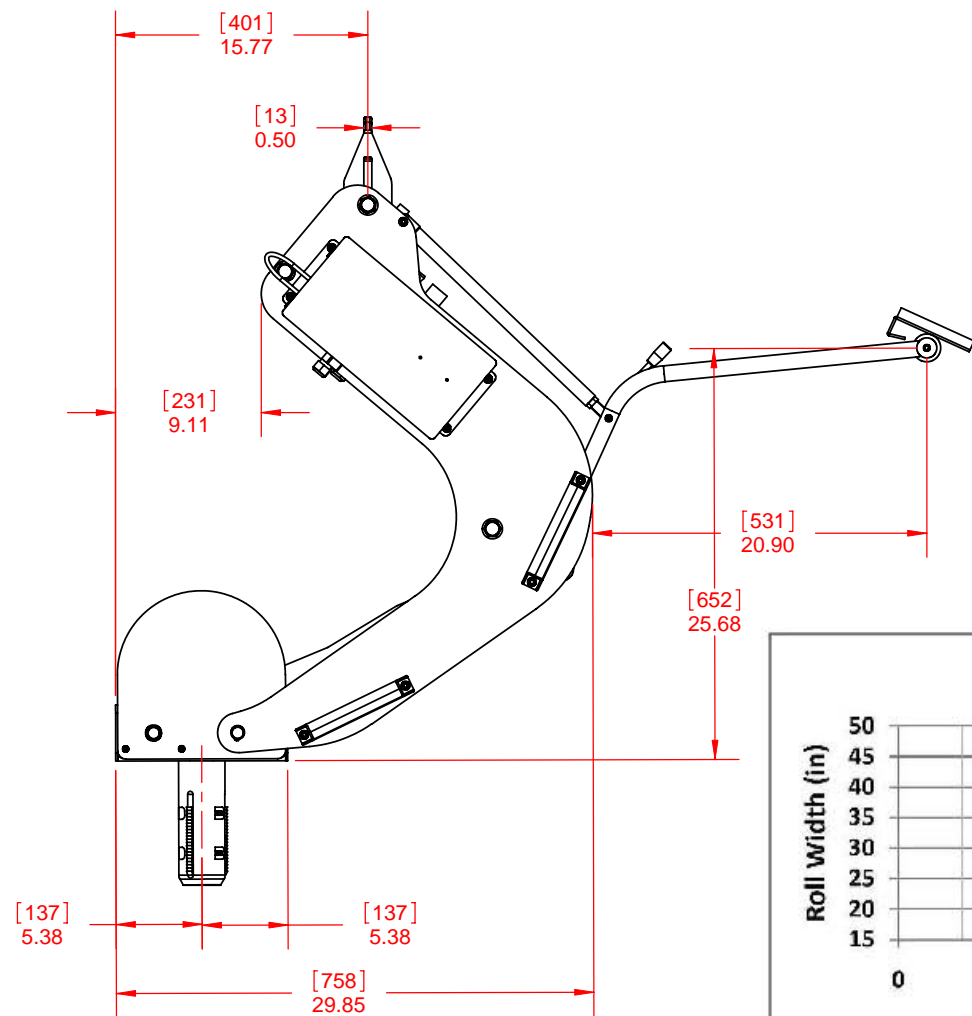
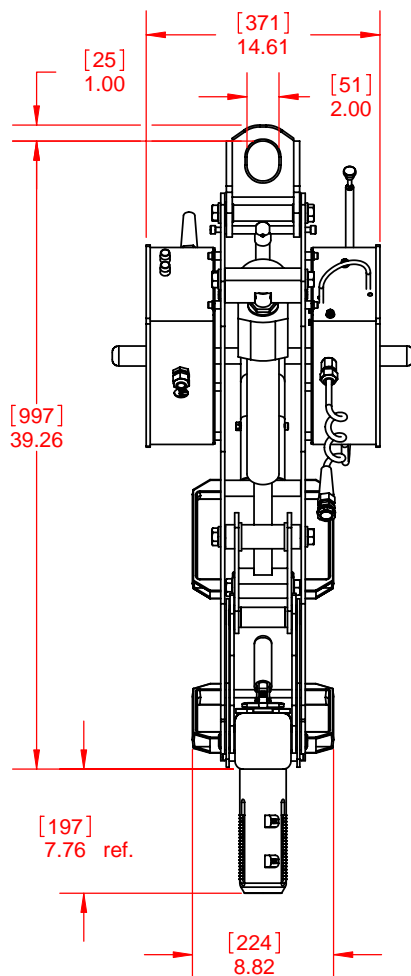

ERT-350-230 VAC  
 Max Capacity: 500 lbs (227 Kg)  
 Max Roll Dia: 36" (914 mm)  
 Max Roll Width: see capacity chart

Item adjustment for Remote Retract Mandrels  
 -1 L-10003-28 Captive Support  
 -1 K040288 M4 x 30 SHCS  
 -1 P10337 M4 Lock Washer

Power Source: 220-240 VAC/1P 50-60 Hz. 5A max.  
 Turning Time: approx. 8 seconds

Accessories shown sold separately. Ref. ONLY

parts marked with (\*) indicate recommended spare parts to be kept on hand, per unit

THE INFORMATION CONTAINED IN THIS DRAWING IS THE SOLE PROPERTY OF SCHLUMPF INC. ANY REPRODUCTION IN PART OR AS A WHOLE WITHOUT WRITTEN PERMISSION OF SCHLUMPF INC. IS PROHIBITED.		PART. NO. <b>L-10789</b>	<p><b>schlumpf</b></p> <p>15 Enterprise Drive; Windham, ME 04062 U.S.A.          Tel: 207-893-1903 Fax: 207-893-1905          E-Mail: mail@schlumpf-inc.com URL: www.schlumpf-inc.com</p>
SIZE <b>B</b>	DO NOT SCALE DRAWING	UNIT WEIGHT (lb) 97.118	
DRAWN BY <b>Rich West</b>	DESIGNED BY <b>Rich West</b>	DATE CREATED 10/2/2009	DATE PRINTED 10/5/2009
MODEL <b>ERT-350-230VAC</b>			

REVISIONS			
REV.	DESCRIPTION	DATE	INITIALS

## ERT accessories

electric mandrel retract kit  
 cable attaches to core-handling mandrel  
 for pushbutton gripper retraction

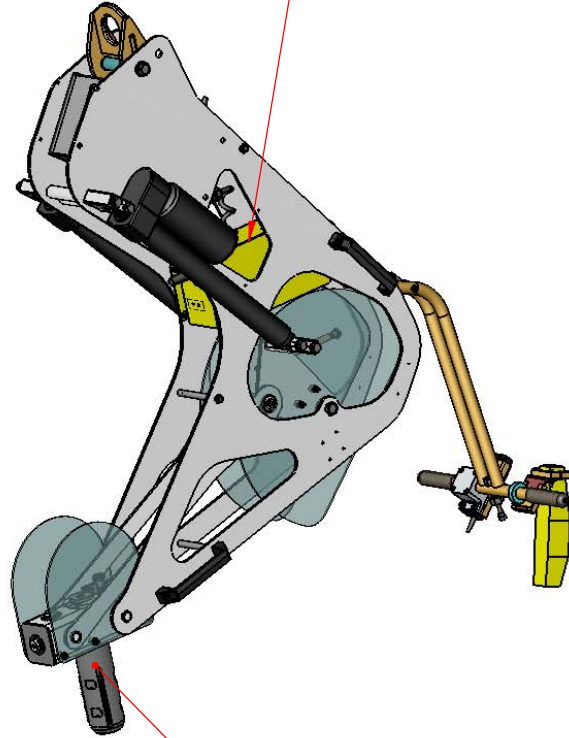

roll core handling mandrel  
 required for most roll handling applications;  
 available in almost any core size bigger than 2"

adjustable gas-spring handle bar

hoist pendant clip  
 base attaches to handle bar;  
 pendant and clip can slide out  
 to walk around unit with pendant in hand

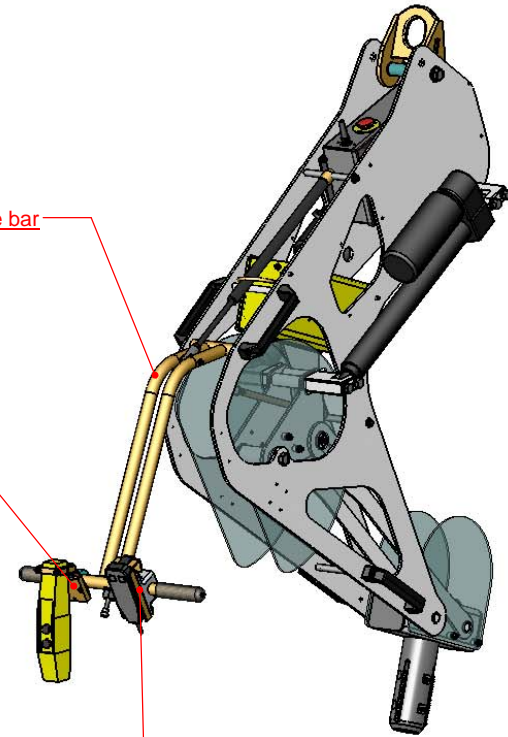

pendant holder  
 docks ERT handheld controller  
 to the handle bar

THE INFORMATION CONTAINED  
 IN THIS DRAWING IS THE SOLE  
 PROPERTY OF SCHLUMPF INC.  
 ANY REPRODUCTION IN PART OR  
 AS A WHOLE WITHOUT WRITTEN  
 PERMISSION OF SCHLUMPF INC.  
 IS PROHIBITED.



15 Enterprise Drive, Windham, ME 04062 U.S.A.  
 Tel: 207-893-1903 Fax: 207-893-1905  
 E-Mail: mail@schlumpf-inc.com URL: www.schlumpf-inc.com

SIZE	DO NOT SCALE DRAWING
<b>A</b>	UNIT WEIGHT (lb) 225.6083747

DRAWN BY  
**Rich West**

DATE CREATED  
 9/10/2004

DATE PRINTED  
 6/29/2007

MODEL

PART. NO.

### REVISIONS

REV.	DESCRIPTION	DATE	INIITALS

# ERT-350 Capacity Chart

