

Schlumpf Ergonomic Handling Systems



- Low Cost
- Modular Design
- Simple Function
- Made In U.S.A.
- Safe, Easy and Economical



ERT-600 electric roll handling machines make lifting, turning and transporting rolls of all types with weights to 600 lbs (272 kg) safe and easy.

The **ERT-600** has quiet, high-speed electric actuators powering the turning function which has the capability of completing the full radius in 18 seconds or less. The 2 station push button switch is mounted within a small, handheld pendant for the operators convenience.

The **ERT-600** utilizes Schlumpf's Universal Mandrels which are available for most core sizes. Simply insert the mandrel into the core and lift the roll. The mandrel grips the core with minimal damage. A quick-change mandrel holder allows fast core size changes without any tools.

"Back Injuries - Nations Number One Workplace Safety Problem." The U.S. Department of Labor reports that more than one million workers suffer back injuries in the U.S. each year, costing industry billions of dollars on top of the pain and suffering borne by employees. Schlumpf Ergonomic Handling Systems will minimize or eliminate the risk of operator injury and maximize productivity and profits.

**LIFT · TURN · TRANSPORT · LOAD · UNLOAD
· STACK · STORE · PACKAGE · PALLETIZE**

ERT-600 Electric Roll Turner

Standard Features:

High speed turning mechanism.
Handles a wide range of roll sizes and weights.
Easy to position and control.
Rugged steel construction.
Modular design.
Made in U.S.A.

Specifications:

Max Roll Width: up to 60"
Max Roll O.D.: 48"
Max Roll Weight: 600 lbs (273 kg)
Paper cores with 3" or 6" I.D.
Power Source: 115 or 240 volt AC
Operator Interface: Hand held pendant with horizontal/vertical switches
Machine Weight: 250 lbs

Options & Accessories:

Single or 2 speed Hoist Controls.
Handle Bar
Anti-telescope Attachment
Expanding mandrels 3" (76 mm) to 12" (304.8 mm)
Pneumatic mandrel retract with switching
Anti-telescoping attachment with manual clamp
Anti-telescoping attachment with pneumatic clamp
Custom configurations available

Minimize Risk. Maximize Profits!

Distributed By:

Specifications and dimensions subject to changes without notice.
Consult Schlumpf for current drawings! Published 05-2006.



innovation. performance. quality.



*Upon Request

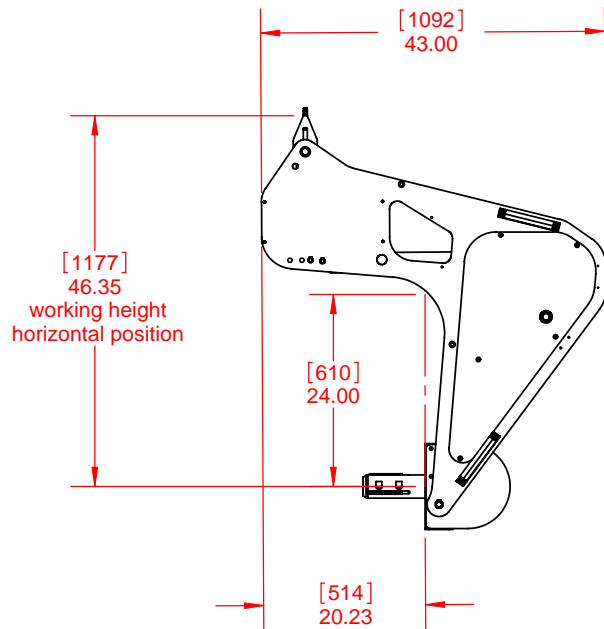
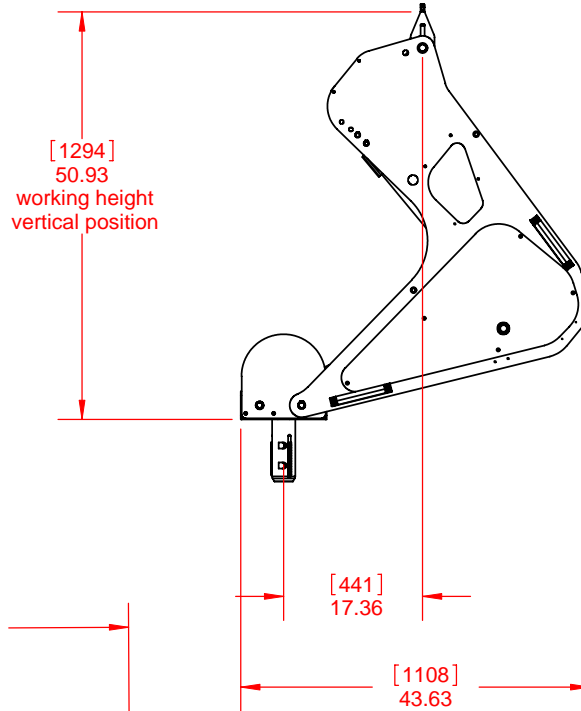
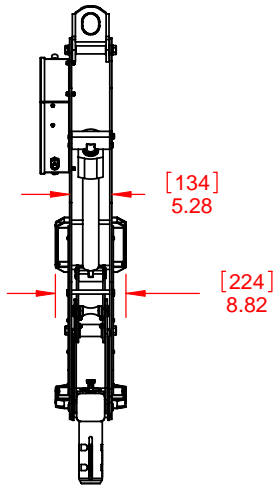

Shown with 3" remote retract mandrel;
MANDRELS SOLD SEPARATELY.

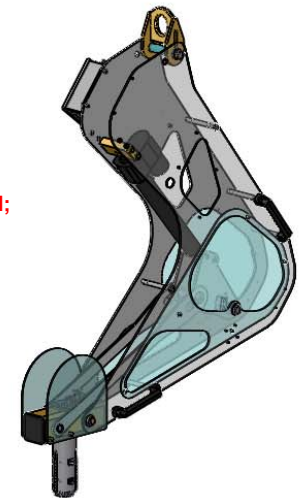

MAX roll ϕ : 48" (1219mm)

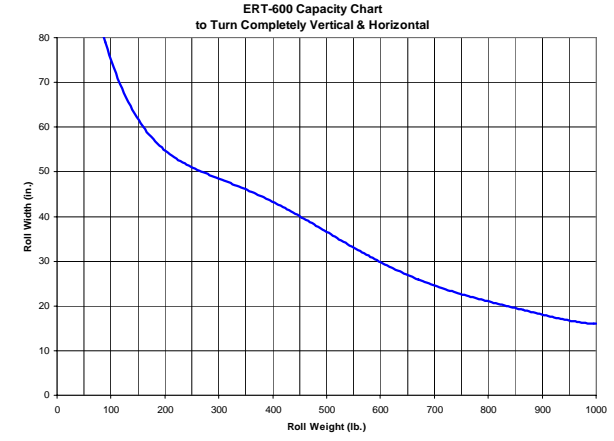

THE INFORMATION CONTAINED IN THIS DRAWING IS THE SOLE PROPERTY OF SCHLUMPF INC. ANY REPRODUCTION IN PART OR AS A WHOLE WITHOUT WRITTEN PERMISSION OF SCHLUMPF INC. IS PROHIBITED.		PART. NO. L-10670	 15 Enterprise Drive, Windham, ME 04062 U.S.A. Tel: 207-893-1903 Fax: 207-893-1905 E-Mail: mail@schlumpf-inc.com URL: www.schlumpf-inc.com
SIZE A	DO NOT SCALE DRAWING	UNIT WEIGHT (lb) 163.956	
DRAWN BY Matthew Skelton		DESIGNED BY Matthew Skelton	DATE CREATED 7/8/2008
MODEL ERT-600 230VAC Electric Roll Turner			DATE PRINTED 7/8/2008

REVISIONS			
REV.	DESCRIPTION	DATE	INITIALS

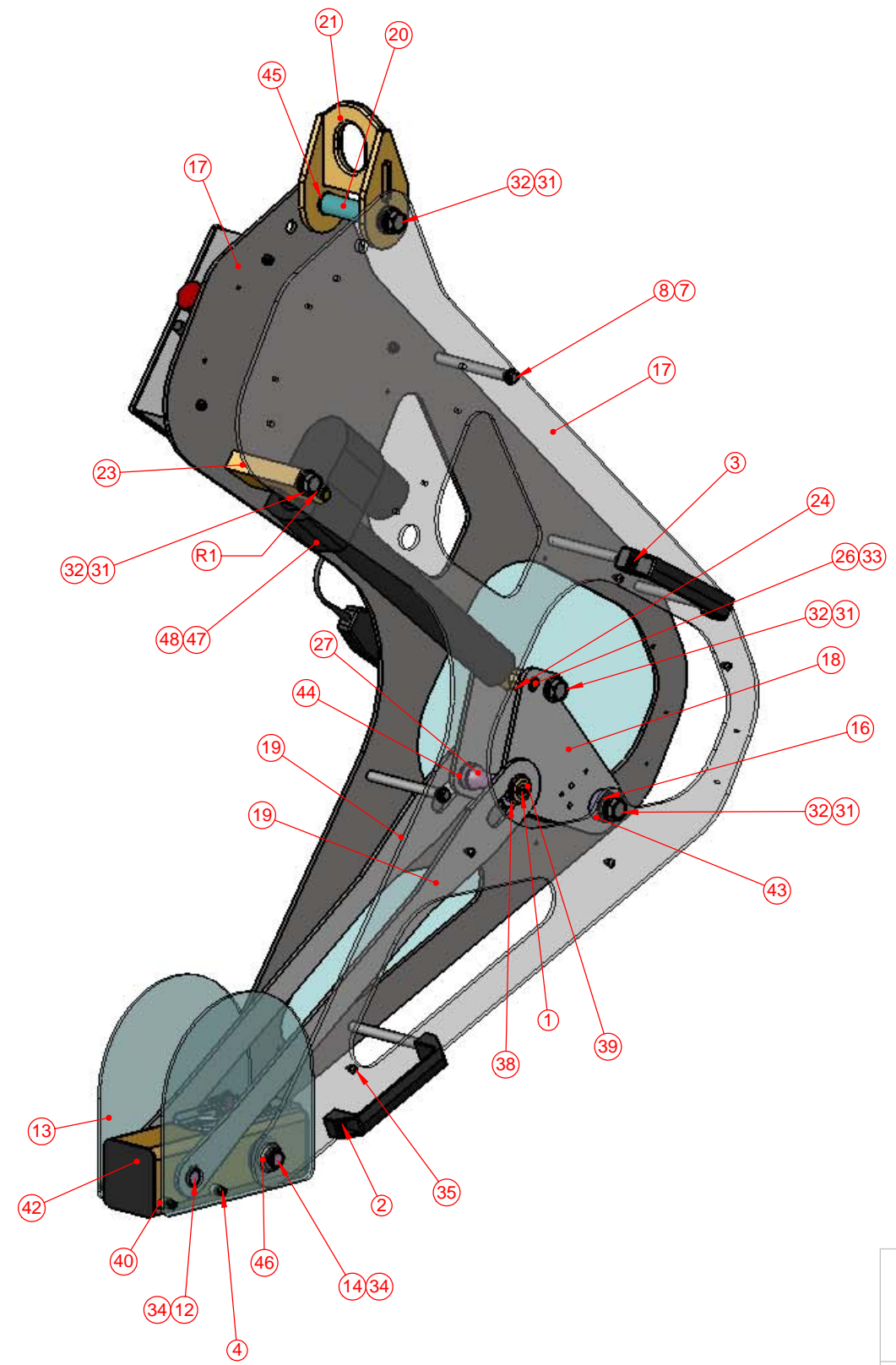
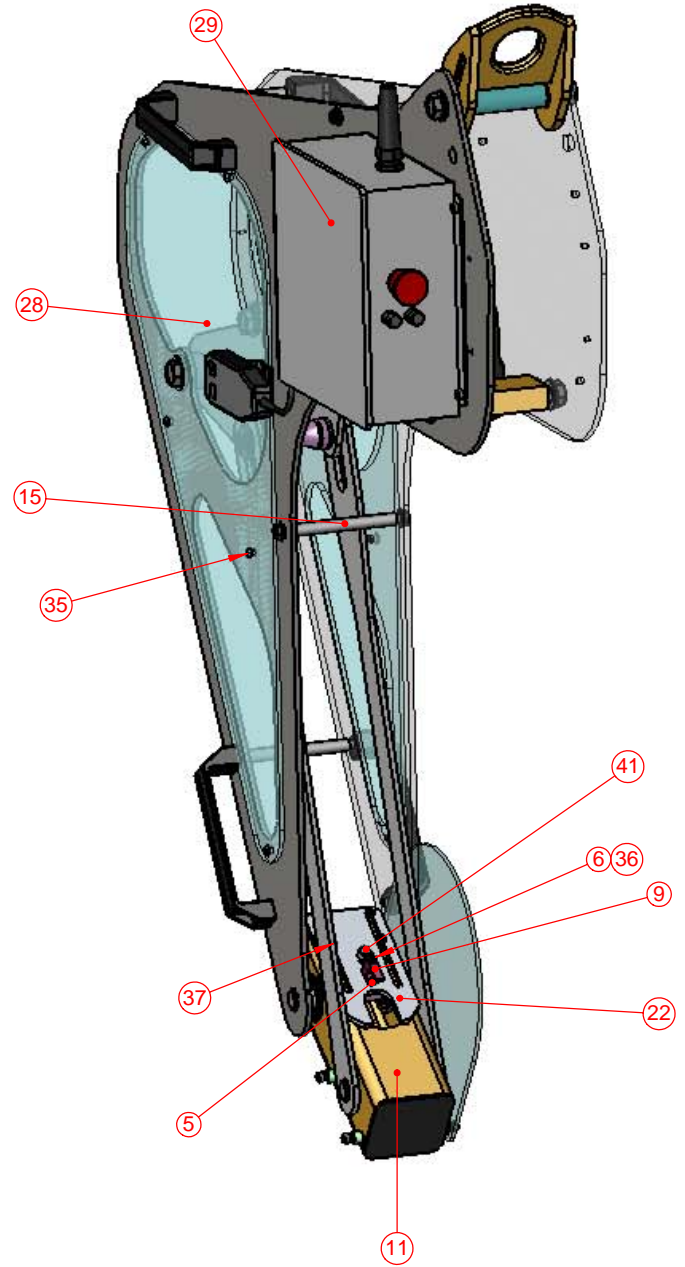

ITEM NO.	PART NUMBER	DESCRIPTION	QTY.
1	K040062	M6 x 1.0 x 16 Socket FCHS	2
2	K040126	M8 x 1.25 x 16 Hex SHCS	2
3	K040127	M8 x 1.25 x 25 Hex SHCS	6
4	K040193	M6 x 1.0 x 25 Hex SHCS	4
5	K040278	M4 x 0.7 x 6 Hex SHCS	1
6	K040288	M4 x 0.7 x 30 Hex SHCS	1
7	K041478	M8 Lock Washer	4
8	K041643	M8 x 1.25 x 20 HHCS	4
9	L-10003-28	Captive Support	1
10	L-10040-05R1	ABS Cover	2
11	L-10335-04R2	ERT-350 Turner Arm	1
12	L-10335-06	ERT Turner Link Shaft	1
13	L-10335-15R3	ERT Turner Guard	2
14	L-10387-01	ERT Turner Shaft	1
15	L-10387-05	ERT Spacer Rod	5
16	L-10387-06	Cam Pivot Shaft	1
17	L-10438-01R3	ERT-600 Frame Plate	2
18	L-10438-02R1	ERT-600 Cam Link	2
19	L-10438-03	ERT-600 Turner Link	2
20	L-10438-05	Hoist Hook Spacer Rod	1
21	L-10438-06	Hoist Hook Weldment	1
22	L-10510-08	Mandrel Locking Plate	1
23	L-10639-02R1	ERT motor end clevis mount	1
24	L-10639-03R2	ERT rod end clevis mount	1
25	L-10639-04R1	ERT motor end clevis shaft	1
26	L-10639-05R1	ERT rod end clevis shaft	1
27	L-10639-06	Cam Link Shaft (single actuator)	1
28	L-10639-07	ERT link guard	2
29	L-10670-01	ERT control box 230VAC std turner & ERR	1
30	P-10033	Plastic Pull Handle	4
31	P-10054	M16 Lock Washer	8
32	P-10099	M16 x 2.0 x 30 HHCS	8
33	P-10123	0.5" Dia. Snap Ring	4
34	P-10135	.75" Dia. Snap Ring	4
35	P-10253	M6 x 1.0 x 8 SBHCS	10
36	P-10337	M4 Lock Washer	1
37	P-10363	1/4 x 5/16 Shoulder Bolt	4
38	P-10672	1" shim washer	4
39	P-10674	M6 Finish Washer	2
40	P-10805	3/8" Spacer	4
41	P-10829	retracting thumb screw	1
42	P-40334	3/4" x 1/2" long flange bushing	2
43	P-40335	1-1/4" x 1" long flange bushing	2
44	P-40336	3/4" x 3/4" long flange bushing	2
45	P-40373	1" ID polymer flange bushing	2
46	P-40374	3/4" ID Radial Ball Bearing	2
47	P-50728	2000lb linear actuator 12" stroke	1
48	P-50728-01R1	Actuator Front Clevis	1

****NOTE: THE FOLLOWING ITEM ADJUSTMENTS ARE MADE FOR REMOTE RETRACT UNITS**

- 1 L-10003-28 CAPTIVE SUPPORT
- 1 K040288 M4 X 30 SHCS
- 1 P-10337 M4 LOCK WASHER

REVISIONS			
REV.	DESCRIPTION	DATE	INITIALS
R1	Actuator and clevis, rigid clevis mounts	2/3/2009	RW

THE INFORMATION CONTAINED IN THIS DRAWING IS THE SOLE PROPERTY OF SCHLUMPF INC. ANY REPRODUCTION IN PART OR AS A WHOLE WITHOUT WRITTEN PERMISSION OF SCHLUMPF INC. IS PROHIBITED.		PART. NO. L-10670R1	 <p>15 Enterprise Drive; Windham, ME 04062 U.S.A. Tel: 207-893-1903 Fax: 207-893-1905 E-Mail: mail@schlumpf-inc.com URL: www.schlumpf-inc.com</p>
SIZE B DO NOT SCALE DRAWING	UNIT WEIGHT (lb) 158.367	DRAWN BY Matthew Skelton	
MODEL ERT-600 230VAC Electric Roll Turner		DESIGNED BY Matthew Skelton	DATE CREATED 7/8/2008 DATE PRINTED 2/3/2009

ERT accessories

electric mandrel retract kit
 cable attaches to core-handling mandrel
 for pushbutton gripper retraction

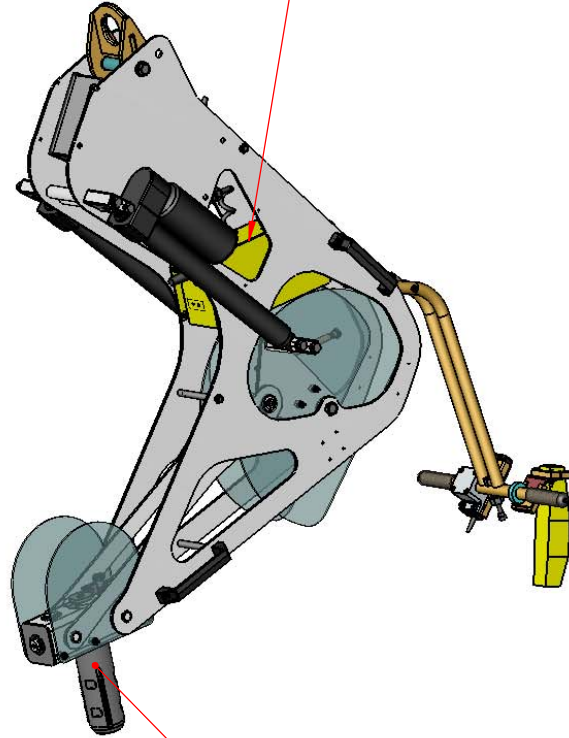

roll core handling mandrel
 required for most roll handling applications;
 available in almost any core size bigger than 2"

adjustable gas-spring handle bar

hoist pendant clip
 base attaches to handle bar;
 pendant and clip can slide out
 to walk around unit with pendant in hand

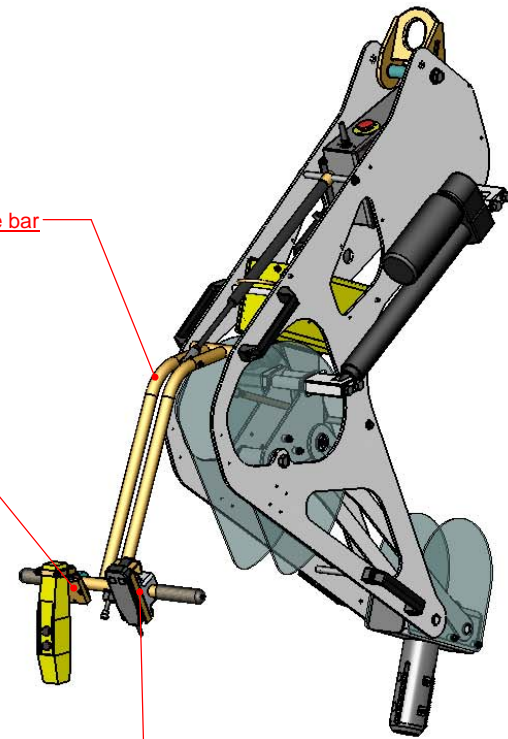

pendant holder
 docks ERT handheld controller
 to the handle bar

THE INFORMATION CONTAINED
 IN THIS DRAWING IS THE SOLE
 PROPERTY OF SCHLUMPF INC.
 ANY REPRODUCTION IN PART OR
 AS A WHOLE WITHOUT WRITTEN
 PERMISSION OF SCHLUMPF INC.
 IS PROHIBITED.



15 Enterprise Drive, Windham, ME 04062 U.S.A.
 Tel: 207-893-1903 Fax: 207-893-1905
 E-Mail: mail@schlumpf-inc.com URL: www.schlumpf-inc.com

SIZE	DO NOT SCALE DRAWING
A	UNIT WEIGHT (lb) 225.6083747

DRAWN BY
Rich West

DATE CREATED
 9/10/2004

DATE PRINTED
 6/29/2007

MODEL
ERT-600 Electric Roll Turner 230VAC

PART. NO.
L-10438

REVISIONS

REV.	DESCRIPTION	DATE	INITIALS

ERT-600 Capacity To Turn Roll Completely Horizontal or Vertical

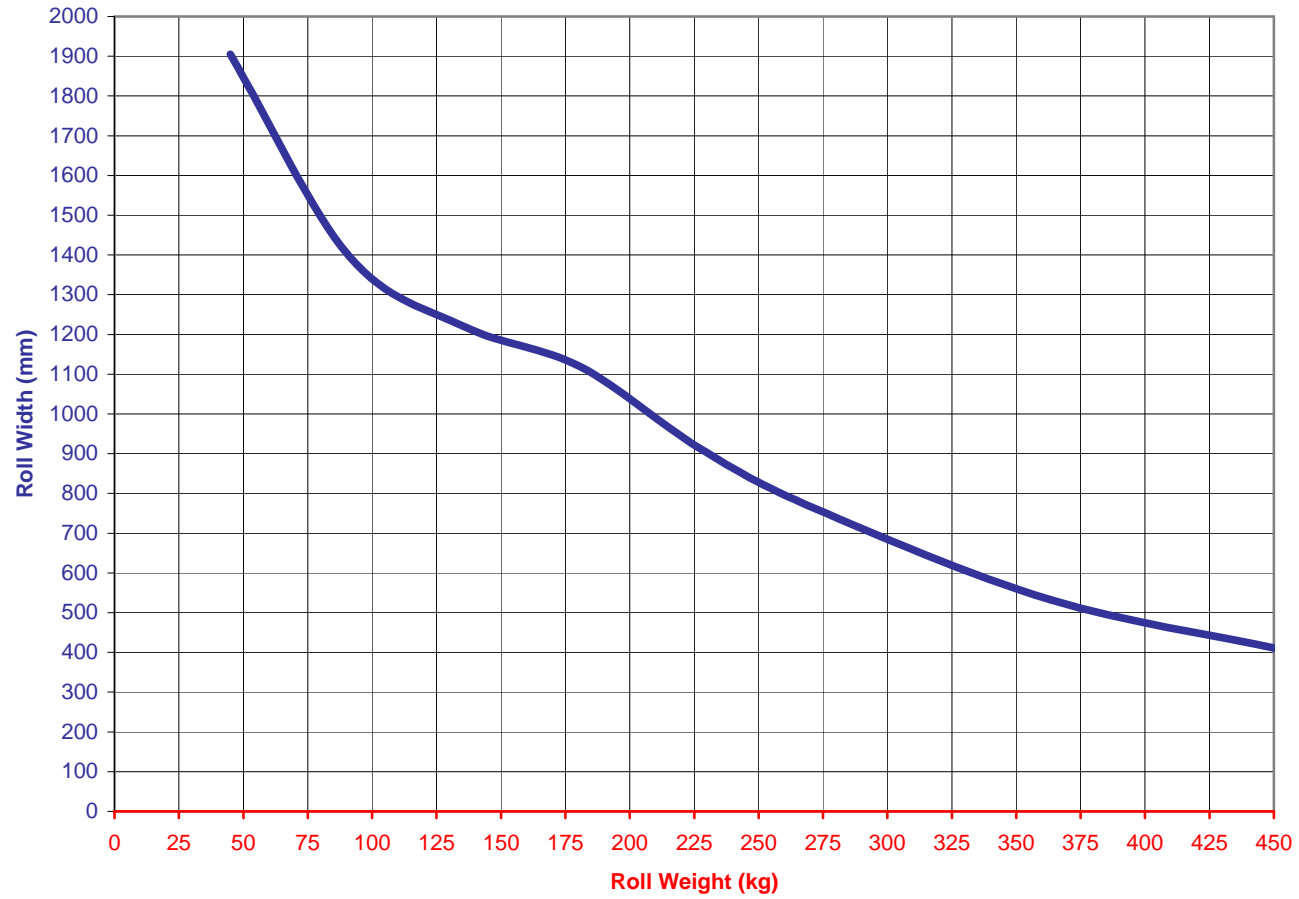

**ERT-600 Capacity Chart
to Turn Completely Vertical & Horizontal**

